

PREMIUM PLASTIC LITHIUM & ALKALINE CELL HOLDERS

For "1/2AA" · "AA" · "2/3A"



SHOWN WITH OPTIONAL RETAINER COVER INSTALLED



1029C RETAINER COVER



108C, 1028C & 1029LC RETAINER COVER

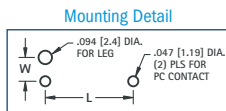
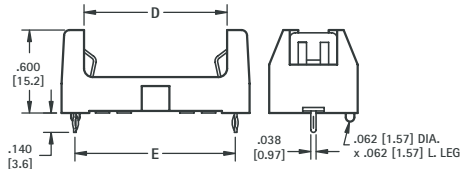
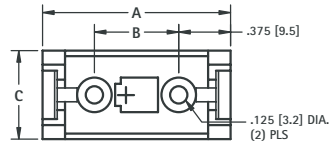

SPECIFICATIONS

Base: PBT, UL Rated 94V-0

Retainer Cover: PBT, UL Rated 94V-0

Contacts: .012 (.30) thick Spring Steel, Tin Nickel Plate

FEATURES

- Snap-In PC contact holds in position for wave soldering
- Tin Nickel Plated contacts for excellent solderability and durability
- Polarity clearly marked for orientation
- Low Profile, space-saving
- Snap-on retainer cover (optional) retains battery securely to withstand shock and vibration. Helps protect against shorting. Tamper-proof.

APPLICATIONS

- Computer memory, power transfer and back-up systems
- Video and telecommunications power back-up requirements
- Preprogrammed video and electronic games
- Microprocessor, microcomputers, minicomputers, notebook, laptop and handheld computer memory hold applications
- Emergency power systems
- Residential, industrial and commercial security and fire alarm systems

| HOLDER CAT. NO. | COVER CAT. NO. | DIMENSIONS | | | | | MTG HOLES | | CELL SIZE | BATTERY CROSS REFERENCE |
|-----------------|-----------------|--------------|--------------|-------------|--------------|--------------|--------------|------------|-----------|---|
| | | A (MAX) | B | C | D | E | L | W | | |
| 108 | 108C | 1.360 (34.5) | .610 (15.5) | .640 (16.3) | 1.030 (26.2) | 1.160 (29.5) | 1.160 (29.5) | .279 (7.1) | "1/2 AA" | Eveready: 544, Duracell: PX28L, Kodak: K28A & KS28, Panasonic: CR14250, Saft: LCP3, Electrochem: 3B955, Maxell: 4LR44, Sanyo: CR14250SE |
| 1028 | 1028C | 2.360 (59.9) | 1.610 (40.9) | .640 (16.3) | 2.030 (51.6) | 2.160 (54.9) | 2.160 (54.9) | .279 (7.1) | "AA" | Eveready: E9, EV15, E91, E177, 505, 1015, Duracell: ZM9, NC15, M15F, TR177, M505, MN1500, PC1500, Panasonic: UM-3 & P-45AA, Sanyo: N-600AA & N-700AA, Rayovac: 5AA, 7AA, 615, 815 |
| 1029 | 1029C 1029LC | 1.700 (43.2) | .950 (24.1) | .720 (18.3) | 1.375 (34.9) | 1.500 (38.1) | 1.500 (38.1) | .320 (8.1) | "2/3 A" | Duracell: DL2/3A, Panasonic: CR123A, Saft: 450SC & VR0450, Electrochem: 3B793 & 3B950, Sanyo: CR17335SE, Kodak: K123L |

RUGGED STEEL & ALUMINUM LITHIUM CELL HOLDERS

STEEL HOLDERS



FIG. 1



FIG. 2

- Available in steel and aluminum
- Ideal for punishing applications
- Sturdily constructed of quality materials
- Contacts made from Brass, Nickel Plate

ADDITIONAL SPECIFICATIONS

Steel Holders: Refer to page 13
Aluminum Holders: Refer to page 15

ALUMINUM HOLDERS

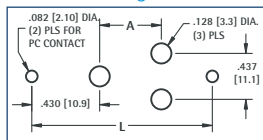

FIG. 3



FIG. 4

Mounting Detail



| STD LUGS CAT. NO. | FIG. NO. | PC LUGS CAT. NO. | FIG. NO. | BATTERY SIZE | BATTERY DIA. | DURA-CELL | PANA-SONIC | SANYO (G.E.) |
|-------------------|----------|------------------|----------|--------------|----------------------------|-----------|------------|--------------|
| 1103 | 2 | 2103 | 1 | "1/2 AA" | .510 × .990 (13.0 × 25.1) | P × 28L | CR14250 | CR14250SE |
| 1105 | 2 | 2105 | 1 | "1/2 A" | .611 × .866 (15.5 × 22.0) | - | BR-1/2A | - |
| 132 | 3 | 131 | 4 | "2/3 A" | .661 × 1.315 (16.8 × 33.4) | DL-2/3A | BR-2/3A | CR17335SE |

Mounting Detail

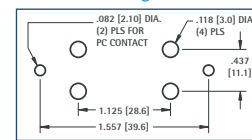

6 VOLT LITHIUM CELL HOLDERS

224



223



- Polarizing Tab for proper orientation
- Lightweight, ideal for rugged applications
- DL223A or Equivalent Batteries

SPECIFICATIONS

Frame: Aluminum 2024-T3 **Terminals:** Brass, Tin Plate

Spring Contacts: .025 (.64) Dia. Spring Steel, Nickel Plate

PC Terminals

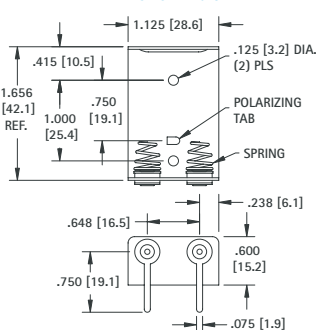

CAT. NO. 224

Quick Fit/Solder Lug

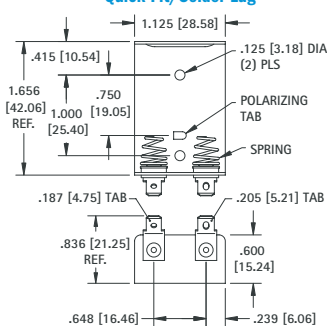

CAT. NO. 223

LITHIUM BATTERY HOLDERS