

10 9 8 7 6 5 4 3 2 1

Part Number	CKT SIZE	VOID POSITION	DIMENSION						PACKING TYPE
			A	B	M	H	T	F	
87951-0001	8	-----	19.90	17.50	10.00	10.30	3.50	23.80	TRAY
87951-0002	8	-----	19.90	17.50	10.00	15.30	3.50	28.80	TRAY

- NOTE:
1. WAFER TO BE FLAT WITHIN 0.003in/in or mm/mm.
 2. MATERIAL: HSG: PA66, GLASS FILLED.
UL-94V-2. COLOR: NATURAL.
PIN: COPPER ALLOY
 3. PLATING FINISH: 100μINCHES MIN TIN OVER
50μINCHES MIN NICKEL UNDERPLATE OVERALL.
 4. PIN PUSHOUT FORCE: 1KG MIN. IN EITHER DIRECTION.
 5. HEADER MAY BE BROKEN TO DESIRE CKT SIZE.
SLIGHTLY FLASHES SHOULD BE ACCEPTED.
 6. PARTS TO BE PACKED IN TRAY.

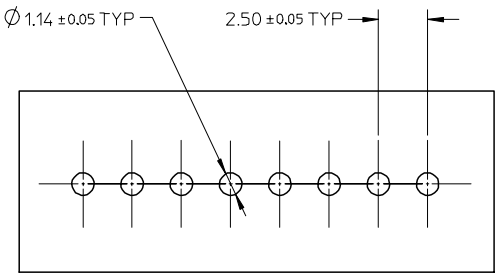
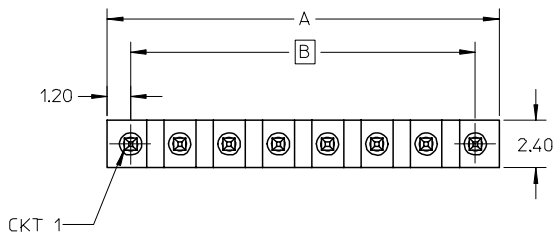

RECOMMENDED P.C.B. HOLE LAYOUT

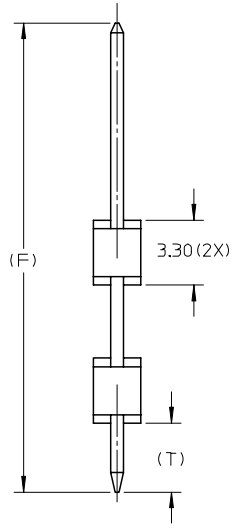
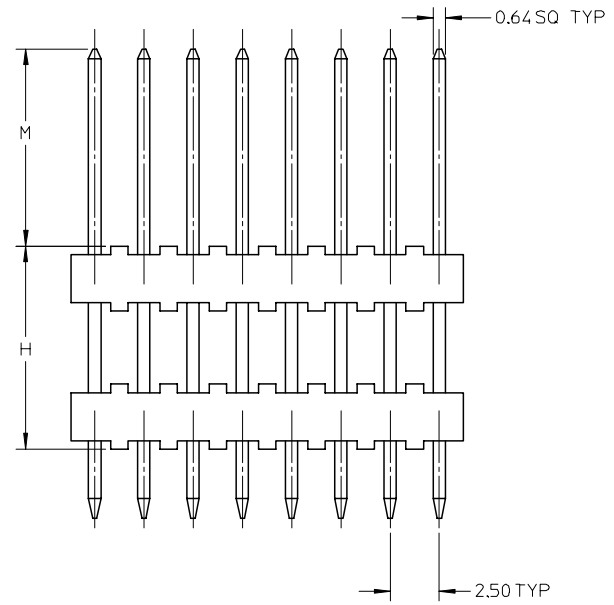

EC NO: S2005-1060 DRWN:KCHO 2005/07/22 CHKD:RAVLN 2005/07/22 APPR:PTLIM 2005/07/25	QUALITY SYMBOLS $\nabla=0$ $\nabla C=0$	GENERAL TOLERANCES (UNLESS SPECIFIED)		DIMENSION STYLE	SCALE	DESIGN UNITS	THIRD ANGLE PROJECTION	
				MM ONLY	NTS	METRIC		
		4 PLACES	± ---	± ---	DRAWN BY	DATE	TITLE	
		3 PLACES	± ---	± ---	YHQ1A0	2004/10/20	SALES DRAWING SINGLE ROW DUAL WAFER 2.50MM PITCH, T/H	
2 PLACES	± 0.25	± ---	CHECKED BY	DATE	MOLEX INCORPORATED			
1 PLACE	± ---	± ---	KMG0H	2004/10/26	SD-87951-001		SHEET NO. 1 OF 1	
ANGULAR ± 3 °		DRAFT WHERE APPLICABLE MUST REMAIN WITHIN DIMENSIONS		APPROVED BY	DATE	DOCUMENT NO.		
				SCLOW	2004/10/26	SEE TABLE		
				MATERIAL NO.				
				SIZE				
				A3				

9 8 7 6 5 4 3 2 1